

DICOFASA®

Diseño Construcciones y Fabricaciones Hispanoamericanas, S.A.

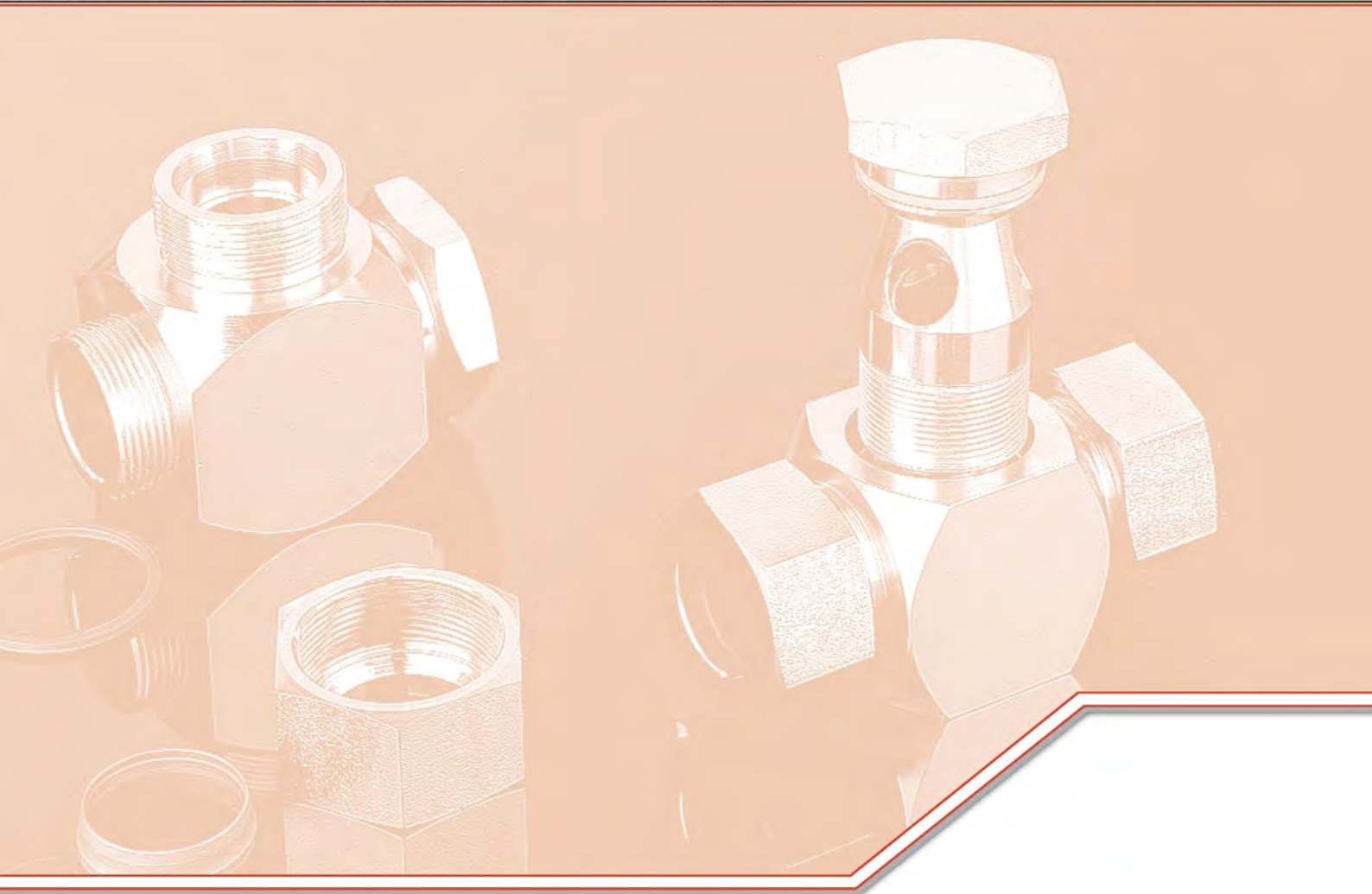

ADAPTADOR RECTO ROSCA MACHO GAS PARA TUBO CILINDRICA PEFLEX ACERO INOXIDABLE

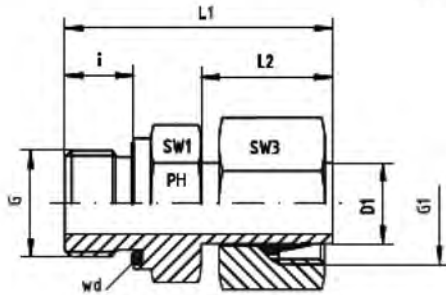

Series	Presión PN	Tubo O.D. D1	Rosca	Dimensiones aproximadas					Código
			G	L1	L2	i	SW1	SW3	
L	315	8	G 1/4 "	41,0	20,5	12	19	17	EVGE-L-08-G 1/4"-wd
L	315	10	G 1/4 "	39,5	20,5	12	19	19	EVGE-L-10-G 1/4"-wd
L	315	12	G 1/4 "	42,0	21,5	12	19	22	EVGE-L-12-G 1/4"-wd
L	315	12	G 3/8 "	45,0	22,0	12	22	22	EVGE-L-12-G 3/8"-wd
L	315	12	G 1/2 "	48,5	22,5	14	27	22	EVGE-L-12-G 1/2"-wd
L	315	15	G 1/2 "	46,0	23,0	14	27	27	EVGE-L-15-G 1/2"-wd
L	315	18	G 1/2 "	47,0	24,0	14	27	32	EVGE-L-18-G 1/2"-wd
L	160	22	G 3/4 "	50,5	24,5	16	32	36	EVGE-L-22-G 3/4"-wd
L	160	28	G 1 "	54,0	25,5	18	41	41	EVGE-L-28-G 1"-wd
L	160	35	G 1 1/4 "	63,5	32,0	20	50	50	EVGE-L-35-G 1 1/4"-wd
L	160	42	G 1 1/2 "	70,0	32,0	22	55	60	EVGE-L-42-G 1 1/2"-wd
S	630	6	G 1/4 "	39,5	20,5	12	19	17	EVGE-S-06-G 1/4"-wd
S	630	8	G 1/4 "	41,0	20,5	12	19	19	EVGE-S-08-G 1/4"-wd
S	630	10	G 3/8 "	44,0	21,0	12	22	22	EVGE-S-10-G 3/8"-wd
S	630	12	G 3/8 "	45,0	22,0	12	22	24	EVGE-S-12-G 3/8"-wd
S	630	12	G 1/2 "	48,5	22,5	14	27	24	EVGE-S-12-G 1/2"-wd
S	400	16	G 1/2 "	51,0	26,0	14	27	30	EVGE-S-16-G 1/2"-wd
S	400	20	G 3/4 "	59,0	29,0	16	32	36	EVGE-S-20-G 3/4"-wd
S	400	25	G 1 "	66,0	33,0	18	41	46	EVGE-S-25-G 1"-wd
S	400	30	G 1 1/4 "	71,0	34,0	20	50	50	EVGE-S-30-G 1 1/4"-wd
S	315	38	G 1 1/2 "	83,5	40,0	22	55	60	EVGE-S-38-G 1 1/2"-wd

ADAPTADOR RECTO ROSCA MACHO GAS PARA TUBO CILINDRICA PEFLEX SIN TUERCA ACERO INOXIDABLE

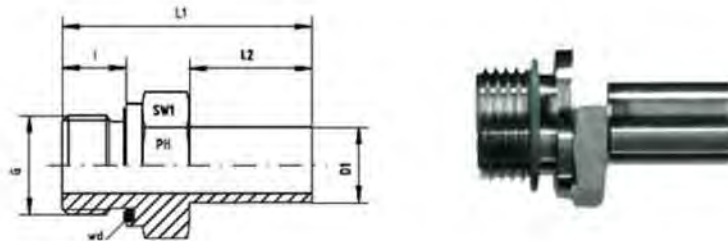

Series	Presión PN	Tubo O.D. D1	Rosca	Dimensiones aproximadas				Código
			G	L1	L2	i	SW1	
L	315	8	G 1/4 "	41,0	20,5	12	19	EVGE-L-08-G 1/4"-ov-wd
L	315	10	G 1/4 "	39,5	20,5	12	19	EVGE-L-10-G 1/4"-ov-wd
L	315	12	G 1/4 "	42,0	21,5	12	19	EVGE-L-12-G 1/4"-ov-wd
L	315	12	G 3/8 "	45,0	22,0	12	22	EVGE-L-12-G 3/8"-ov-wd
L	315	15	G 1/2 "	46,0	23,0	14	27	EVGE-L-15-G 1/2"-ov-wd
S	630	12	G 3/8 "	45,0	22,0	12	22	EVGE-S-12-G 3/8"-ov-wd
S	630	12	G 1/2 "	48,5	22,5	14	27	EVGE-S-12-G 1/2"-ov-wd

ADAPTADOR RECTO ROSCA MACHO NPT ACERO INOXIDABLE

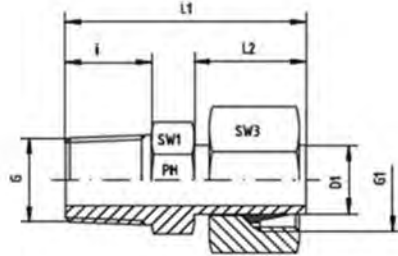

Series	Presión PN	Tubo O.D. D1	Rosca		Dimensiones aproximadas					Código
			G	G1	L1	L2	i	SW1	SW3	
L	315	6	1/4" NPT	M 12 x 1,5	40,0	19,0	15,0	14	14	EVGE-L-06-1/4"-NPT
L	315	8	1/4" NPT	M 14 x 1,5	40,5	20,0	15,0	14	17	EVGE-L-08-1/4"-NPT
L	315	10	1/4" NPT	M 16 x 1,5	39,5	19,0	15,0	14	19	EVGE-L-10-1/4"-NPT
L	315	12	1/4" NPT	M 18 x 1,5	42,0	22,0	15,0	14	22	EVGE-L-12-1/4"-NPT
L	315	12	3/8" NPT	M 18 x 1,5	43,0	22,0	15,3	19	22	EVGE-L-12-3/8"-NPT
L	315	15	1/2" NPT	M 22 x 1,5	48,0	22,0	20,0	22	27	EVGE-L-15-1/2"-NPT
L	160	18	1/2" NPT	M 26 x 1,5	50,0	24,0	20,0	22	32	EVGE-L-18-1/2"-NPT
L	160	22	3/4" NPT	M 30 x 2	52,0	24,5	20,0	27	36	EVGE-L-22-3/4"-NPT
L	160	28	1" NPT	M 36 x 2	59,0	25,5	25,0	36	41	EVGE-L-28-1"-NPT
L	160	35	1 1/4" NPT	M 45 x 2	63,0	28,5	25,5	46	50	EVGE-L-35-1 1/4"-NPT
L	160	42	1 1/2" NPT	M 52 x 2	66,0	29,0	26,0	50	60	EVGE-L-42-1 1/2"-NPT
S	630	6	1/4" NPT	M 14 x 1,5	40,0	19,0	15,0	14	17	EVGE-S-06-1/4"-NPT
S	630	8	1/4" NPT	M 16 x 1,5	40,5	20,0	15,0	14	19	EVGE-S-08-1/4"-NPT
S	630	10	3/8" NPT	M 18 x 1,5	44,0	21,0	15,3	19	22	EVGE-S-10-3/8-NPT "
S	630	12	3/8" NPT	M 20 x 1,5	43,0	22,0	15,3	19	24	EVGE-S-12-3/8-NPT "
S	630	12	1/2" NPT	M 20 x 1,5	50,0	22,0	20,0	22	24	EVGE-S-12-1/2-NPT "
S	400	16	1/2" NPT	M 24 x 1,5	54,0	24,0	20,0	22	30	EVGE-S-16-1/2-NPT "
S	400	20	3/4" NPT	M 30 x 2	58,0	28,0	20,0	27	36	EVGE-S-20-3/4-NPT "
S	400	25	1" NPT	M 36 x 2	68,0	29,0	25,0	36	46	EVGE-S-25-1-NPT "
S	400	30	1 1/4" NPT	M 42 x 2	73,0	33,0	25,5	46	50	EVGE-S-30-1 1/4-NPT "
S	315	38	1 1/2" NPT	M 52 x 2	81,0	38,0	26,0	50	60	EVGE-S-38-1 1/2-NPT "

ANILLO CORTANTE ACERO INOXIDABLE



Tubo O.D. D1	L1	DN 3861	Código
15	10,0	BL 15	SR-L-15/2 K
18	10,0	BL 18	SR-L-18/2 K
22	11,0	BL 22	SR-L-22/2 K
28	11,0	BL 28	SR-L-28/2 K
35	13,5	BL 35	SR-L-35/2 K
42	13,5	BL 42	SR-L-42/2 K
6	9,0	BS 6	SR-S-06/2 K
8	9,0	BS 8	SR-S-08/2 K
10	9,5	BS 10	SR-S-10/2 K
12	10,0	BS 12	SR-S-12/2 K
14	9,5	BS 14	SR-S-14/2 K
16	10,0	BS 16	SR-S-16/2 K
20	11,5	BS 20	SR-S-20/2 K
25	12,5	BS 25	SR-S-25/2 K
30	12,5	BS 30	SR-S-30/2 K
38	13,5	BS 38	SR-S-38/2 K

BOQUILLA DE SOLDADURA CON ESTANQUEIDAD DE JUNTA TORICA ACERO INOXIDABLE

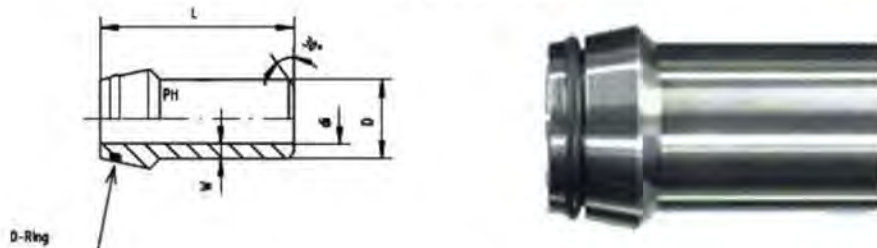

Series	Presión PN	D x W	Dimensiones aproximadas		O-Ring	Código
			di	L		
L + S	414	8 x 1,5	5	31,0	6,0 x 1,5	SKV-8x1,5
L + S	528	8 x 2	4	31,0	6,0 x 1,5	SKV-8x2
L + S	358	10 x 1,5	7	32,5	8,0 x 1,5	SKV-10x1,5
L + S	460	10 x 2	6	32,5	8,0 x 1,5	SKV-10x2
L + S	305	12 x 1,5	9	32,5	10,0 x 1,5	SKV-12x1,5
L + S	393	12 x 2	8	32,5	10,0 x 1,5	SKV-12x2
L + S	476	12 x 2,5	7	32,5	10,0 x 1,5	SKV-12x2,5
S	343	14 x 2	10	40,0	10,0 x 2,0	SKV-14x2
L	270	15 x 1,5	12	36,0	12,0 x 2,0	SKV-15x1,5
L	323	15 x 2	11	36,0	12,0 x 2,0	SKV-15x2
S	305	16 x 2	12	38,5	13,0 x 2,0	SKV-16x2
S	372	16 x 2,5	11	38,5	13,0 x 2,0	SKV-16x2,5
L	300	18 x 2	14	37,0	15,0 x 2,0	SKV-18x2
S	249	20 x 2	16	44,5	16,0 x 2,0	SKV-20x2
S	460	20 x 4	12	44,5	16,3 x 2,4	SKV-20x4
L	245	22 x 2	18	38,5	19,0 x 2,0	SKV-22x2
L	280	22 x 2,5	17	38,5	19,0 x 2,0	SKV-22x2,5
S	294	25 x 3	19	49,5	21,3 x 2,4	SKV-25x3
S	379	25 x 4	17	49,5	21,3 x 2,4	SKV-25x4
L	193	28 x 2	24	41,5	25,0 x 2,0	SKV-28x2
L	224	28 x 2,5	23	41,5	25,0 x 2,0	SKV-28x2,5
S	249	30 x 3	27	52,0	25,3 x 2,4	SKV-30x3
S	323	30 x 4	22	52,0	25,3 x 2,4	SKV-30x4
L	231	35 x 3	29	47,0	32,0 x 2,5	SKV-35x3
S	261	38 x 4	30	56,5	34,0 x 2,5	SKV-38x4
S	319	38 x 5	28	56,5	34,0 x 2,5	SKV-38x5
L	182	42 x 3	36	47,0	38,0 x 2,5	SKV-42x3

CODO ORIENTABLE EJECUCION ENCHUFE ROSCA MACHO GAS PARA TUBO CILINDRICA ACERO INOXIDABLE

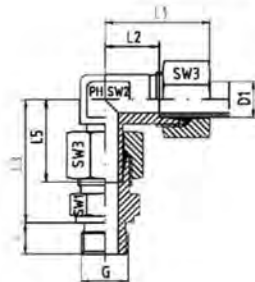

Series	Presión PN	Tubo O.D. D1	Rosca G	Dimensiones aproximadas								Código
				L1	L2	L3	L5	i	SW1	SW2	SW3	
S	400	16	G 1/2 "	43	24,5	55,0	36,5	14	27	24	30	EVW-S-16-G 1/2 "

RACOR DE REDUCCION RECTO UNION ACERO INOXIDABLE

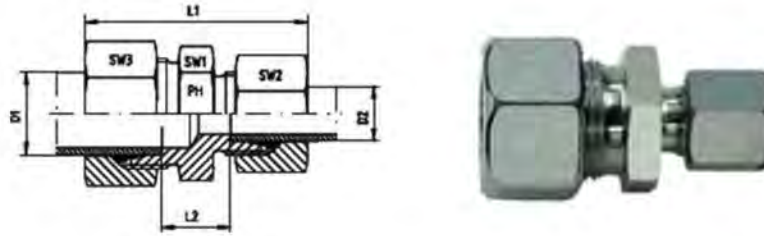

Series	Presión PN	Tubo O.D.		Dimensiones aproximadas					Código
		D1	D2	L1	L2	SW1	SW2	SW3	
L	315	8	6	45,5	11,0	14	14	17	GRV-L-08/06
L	315	10	6	47,0	12,0	17	14	19	GRV-L-10/06
L	315	10	8	47,0	12,0	17	17	19	GRV-L-10/08
L	315	12	6	48,0	13,0	19	14	22	GRV-L-12/06
L	315	12	8	48,0	13,0	19	17	22	GRV-L-12/08
L	315	12	10	49,5	14,0	19	19	22	GRV-L-12/10
L	315	15	10	52,0	15,0	24	19	27	GRV-L-15/10
L	315	15	12	52,0	15,0	24	22	27	GRV-L-15/12
S	630	8	6	52,5	18,0	17	17	19	GRV-S-08/06
S	630	10	6	53,5	17,5	19	17	22	GRV-S-10/06
S	630	10	8	54,0	17,5	19	19	22	GRV-S-10/08
S	630	12	8	55,5	19,5	22	19	24	GRV-S-12/08
S	630	12	10	56,5	19,0	22	22	24	GRV-S-12/10
S	400	16	10	60,5	20,0	27	22	30	GRV-S-16/10
S	400	16	12	60,5	20,0	27	24	30	GRV-S-16/12
S	400	20	10	65,5	22,0	32	22	36	GRV-S-20/10
S	400	20	12	65,5	22,0	32	24	36	GRV-S-20/12
S	400	25	20	79,0	25,5	41	36	46	GRV-S-25/20
S	315	38	30	95,5	29,5	55	50	60	GRV-S-38/30

RACOR EN CODO ACERO INOXIDABLE

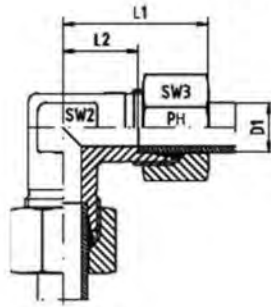

Series	Presión PN	Tubo O.D. D1	Dimensiones aproximadas				Código
			L1	L2	SW2	SW3	
L	315	6	27	12,0	12	14	WV-L-06
L	315	8	29	14,0	12	17	WV-L-08
L	315	10	30	15,0	14	19	WV-L-10
L	315	12	32	17,0	17	22	WV-L-12
L	315	15	36	21,0	19	27	WV-L-15
L	315	18	40	23,5	24	32	WV-L-18
L	160	22	44	27,5	27	36	WV-L-22
L	160	28	47	30,5	36	41	WV-L-28
L	160	35	56	34,5	41	50	WV-L-35
L	160	42	63	40,0	50	60	WV-L-42
S	630	6	31	16,0	12	17	WV-S-06
S	630	8	32	17,0	14	19	WV-S-08
S	630	10	34	17,5	17	22	WV-S-10
S	630	12	38	21,5	17	24	WV-S-12
S	630	14	40	22,0	19	27	WV-S-14
S	400	16	43	24,5	24	30	WV-S-16
S	400	20	48	26,5	27	36	WV-S-20
S	400	25	54	30,0	36	46	WV-S-25
S	315	38	72	41,0	50	60	WV-S-38

RACOR EN T ACERO INOXIDABLE

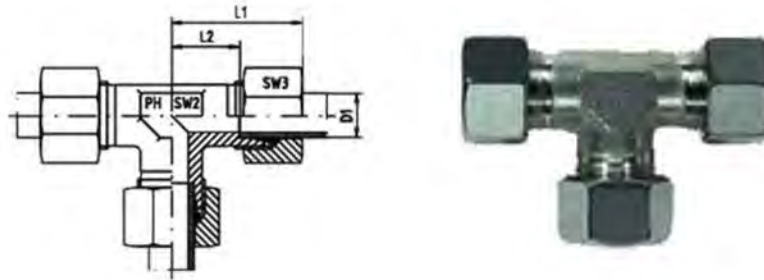

Series	Presión PN	Tubo O.D. D1	Dimensiones aproximadas				Código
			L1	L2	SW2	SW3	
L	315	6	27	12,0	12	14	TV-L-06
L	315	8	29	14,0	12	17	TV-L-08
L	315	10	30	15,0	14	19	TV-L-10
L	315	12	32	17,0	17	22	TV-L-12
L	315	15	36	21,0	19	27	TV-L-15
L	315	18	40	23,5	24	32	TV-L-18
L	160	22	44	27,5	27	36	TV-L-22
L	160	28	47	30,5	36	41	TV-L-28
L	160	35	56	34,5	41	50	TV-L-35
L	160	42	63	40,0	50	60	TV-L-42
S	630	6	31	16,0	12	17	TV-S-06
S	630	8	32	17,0	14	19	TV-S-08
S	630	10	34	17,5	17	22	TV-S-10
S	630	12	38	21,5	17	24	TV-S-12
S	400	16	43	24,4	24	30	TV-S-16
S	400	20	48	26,5	27	36	TV-S-20
S	400	25	54	30,0	36	46	TV-S-25
S	400	30	62	35,5	41	50	TV-S-30
S	315	38	72	41,0	50	60	TV-S-38

RACOR HEMBRA RECTO ROSCA GAS ACERO INOXIDABLE

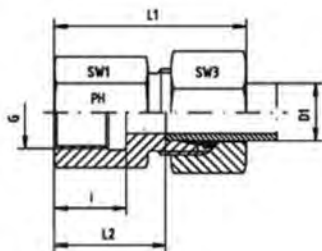

Series	Presión PN	Tubo O.D. D1	Rosca	Dimensiones aproximadas					Código
			G	L1	L2	i	SW1	SW3	
L	315	6	G 1/8 "	36,0	19,0	12,0	14	14	GAI-L-06-G 1/8 "
L	315	6	G 1/4 "	41,0	24,0	17,0	19	14	GAI-L-06-G 1/4 "
L	315	6	G 3/8 "	42,0	24,0	17,0	24	14	GAI-L-06-G 3/8 "
L	315	6	G 1/2 "	46,0	31,0	20,0	27	14	GAI-L-06-G 1/2 "
L	315	8	G 1/4 "	41,0	24,0	17,0	19	17	GAI-L-08-G 1/4 "
L	315	8	G 3/8 "	42,0	25,0	17,0	24	17	GAI-L-08-G 3/8 "
L	315	8	G 1/2 "	46,0	32,0	20,0	27	17	GAI-L-08-G 1/2 "
L	315	10	G 1/4 "	42,0	25,0	17,0	19	19	GAI-L-10-G 1/4 "
L	315	10	G 3/8 "	43,0	26,0	17,0	24	19	GAI-L-10-G 3/8 "
L	315	10	G 1/2 "	47,0	30,0	20,0	27	19	GAI-L-10-G 1/2 "
L	315	12	G 1/4 "	42,0	25,0	17,0	19	22	GAI-L-12-G 1/4 "
L	315	12	G 3/8 "	43,0	26,0	17,0	24	22	GAI-L-12-G 3/8 "
L	315	12	G 1/2 "	48,0	30,0	20,0	27	22	GAI-L-12-G 1/2 "
L	315	15	G 3/8 "	46,0	27,0	17,5	24	27	GAI-L-15-G 3/8 "
L	315	15	G 1/2 "	49,0	31,0	20,0	27	27	GAI-L-15-G 1/2 "
L	315	18	G 3/8 "	47,0	26,5	17,5	27	32	GAI-L-18-G 3/8 "
L	315	18	G 1/2 "	50,5	30,5	20,0	27	32	GAI-L-18-G 1/2 "
L	160	22	G 1/2 "	55,0	33,5	20,0	32	36	GAI-L-22-G 1/2 "
L	160	22	G 3/4 "	56,0	35,5	22,0	36	36	GAI-L-22-G 3/4 "
L	160	28	G 1 "	60,5	38,0	24,5	41	41	GAI-L-28-G 1 "
L	160	35	G 1 1/4 "	68,5	41,0	26,5	55	50	GAI-L-35-G 1 1/4 "
L	160	42	G 1 1/2 "	69,5	42,5	28,5	60	60	GAI-L-42-G 1 1/2 "

RACOR HEMBRA RECTO ROSCA GAS ACERO INOXIDABLE

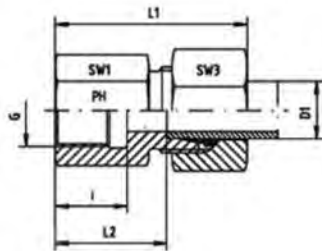

Series	Presión PN	Tubo O.D. D1	Rosca		Dimensiones aproximadas				Código
			G	L1	L2	i	SW1	SW3	
S	400	6	G 1/4 "	42,0	26,0	17,0	19	17	GAI-S-06-G 1/4 "
S	400	8	G 1/4 "	43,0	26,0	17,0	19	19	GAI-S-08-G 1/4 "
S	400	10	G 3/8 "	45,0	26,5	17,0	24	22	GAI-S-10-G 3/8 "
S	400	10	G 1/2 "	49,5	30,5	20,0	27	22	GAI-S-10-G 1/2 "
S	400	12	G 1/4 "	46,0	27,5	17,0	22	24	GAI-S-12-G 1/4 "
S	400	12	G 3/8 "	45,0	26,5	17,0	24	24	GAI-S-12-G 3/8 "
S	400	12	G 1/2 "	50,0	30,5	20,0	27	24	GAI-S-12-G 1/2 "
S	400	14	G 3/8 "	50,0	30,0	17,0	24	27	GAI-S-14-G 3/8 "
S	400	14	G 1/2 "	52,0	32,0	20,0	27	27	GAI-S-14-G 1/2 "
S	400	16	G 3/8 "	48,0	26,5	17,5	27	30	GAI-S-16-G 3/8 "
S	400	16	G 1/2 "	53,0	31,5	20,0	27	30	GAI-S-16-G 1/2 "
S	315	20	G 1/2 "	57,0	32,5	20,0	32	36	GAI-S-20-G 1/2 "
S	315	20	G 3/4 "	60,0	34,5	22,0	32	36	GAI-S-20-G 3/4 "
S	315	25	G 3/4 "	60,0	35,0	22,0	41	46	GAI-S-25-G 3/4 "

RACOR HEMBRA RECTO ROSCA NPT ACERO INOXIDABLE

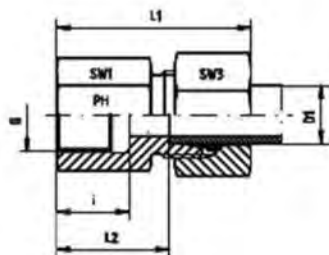

Series	Presión PN	Tubo O.D. D1	Rosca	Dimensiones aproximadas					Código
			G	L1	L2	i	SW1	SW3	
L	315	6	1/8 NPT "	34	19,0	11,6	14	14	GAI-L-06-1/8"-NPT
L	315	6	1/4 NPT "	38	23,5	16,4	19	14	GAI-L-06-1/4"-NPT
L	315	8	1/4 NPT "	38	23,5	16,4	19	17	GAI-L-08-1/4"-NPT
L	315	10	1/4 NPT "	39	24,0	16,4	19	19	GAI-L-10-1/4"-NPT
L	315	10	3/8 NPT "	43	26,0	17,4	24	19	GAI-L-10-3/8"-NPT
L	315	10	1/2 NPT "			22,6	27	19	GAI-L-10-1/2"-NPT
L	315	12	3/8 NPT "	42	27,0	17,4	24	22	GAI-L-12-3/8"-NPT
L	315	12	1/2 NPT "	47	32,0	22,6	27	22	GAI-L-12-1/2"-NPT
L	315	15	1/2 NPT "	48	33,0	22,6	27	27	GAI-L-15-1/2"-NPT
L	315	18	1/2 NPT "	49	32,5	22,6	27	27	GAI-L-18-1/2"-NPT
L	160	22	3/4 NPT "	52	35,5	23,1	36	36	GAI-L-22-3/4"-NPT
L	160	28	1 NPT "	57	40,5	27,8	41	41	GAI-L-28-1"-NPT
L	160	35	1 1/4 NPT "	62	40,5	28,3	55	50	GAI-L-35-1 1/4"-NPT
L	160	42	1 1/2 NPT "	65	42,0	28,3	60	60	GAI-L-42-1 1/2"-NPT
S	630	6	1/4 NPT "	41	26,0	16,4	19	17	GAI-S-06-1/4"-NPT
S	630	8	1/4 NPT "	41	26,0	16,4	19	19	GAI-S-08-1/4"-NPT
S	630	10	3/8 NPT "	44	27,0	17,4	24	22	GAI-S-10-3/8"-NPT
S	630	12	3/8 NPT "	44	27,5	17,4	24	24	GAI-S-12-3/8"-NPT
S	630	12	1/2 NPT "	50	33,5	22,6	27	24	GAI-S-12-1/2"-NPT
S	400	16	1/2 NPT "	50	34,5	22,6	27	30	GAI-S-16-1/2"-NPT
S	400	20	3/4 NPT "	57	35,5	23,1	32	36	GAI-S-20-3/4"-NPT
S	400	25	1 NPT "	65	41,0	27,8	41	46	GAI-S-25-1"-NPT

RACOR MACHO DE CODO ROSCA FINA METRICA CONICA ACERO INOXIDABLE

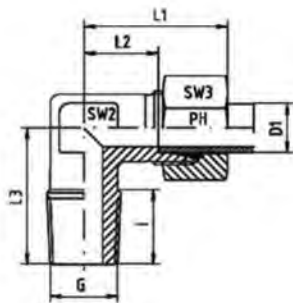

Series	Presión PN	Tubo O.D. D1	Rosca G	Dimensiones aproximadas						Código
				L1	L2	L3	i	SW2	SW3	
L	315	15	M 18 x 1,5 keg	36	21,0	32	12	19	27	WE-L-15-M 18x1,5-k
S	400	8	M 14 x 1,5 keg	32	17,0	27	12	14	19	WE-S-08-M 14x1,5-k

RACOR MACHO DE CODO ROSCA GAS PARA TUBO CONICA ACERO INOXIDABLE

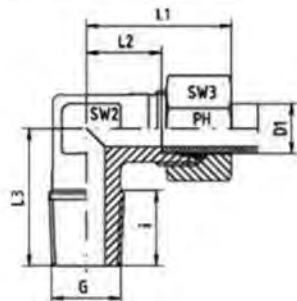

Series	Presión PN	Tubo O.D. D1	Rosca G	Dimensiones aproximadas						Código
				L1	L2	L3	i	SW2	SW3	
L	315	12	R 3/8 keg "	32,0	17,5	28	12	17	22	WE-L-12-R 3/8"-k

RACOR MACHO DE CODO ROSCA NPT ACERO INOXIDABLE



Series	Presión PN	Tubo O.D. D1	Rosca G	Dimensiones aproximadas						Código
				L1	L2	L3	i	SW2	SW3	
L	315	6	1/8" NPT	27,0	12,0	20	10,0	12	14	WE-L-06-1/8"-NPT
L	315	6	1/4" NPT	29,0	14,0	26	15,0	12	14	WE-L-06-1/4"-NPT
L	315	8	1/8" NPT	29,0	14,0	26	10,0	12	17	WE-L-08-1/8"-NPT
L	315	8	1/4" NPT	29,0	14,0	26	15,0	12	17	WE-L-08-1/4"-NPT
L	315	10	1/4" NPT	30,0	15,0	27	15,0	14	19	WE-L-10-1/4"-NPT
L	315	10	3/8" NPT	32,0	17,0	28	15,3	14	19	WE-L-10-3/8"-NPT
L	315	12	1/4" NPT	32,0	17,0	28	15,0	17	22	WE-L-12-1/4"-NPT
L	315	12	3/8" NPT	32,0	17,0	28	15,3	17	22	WE-L-12-3/8"-NPT
L	315	12	1/2" NPT	36,0	21,0	34	20,0	17	22	WE-L-12-1/2"-NPT
L	315	15	1/2" NPT	36,0	21,0	34	20,0	19	27	WE-L-15-1/2"-NPT
L	315	18	1/2" NPT	40,0	23,5	36	20,0	24	32	WE-L-18-1/2"-NPT
L	160	22	3/4" NPT	44,0	27,5	42	20,0	27	36	WE-L-22-3/4"-NPT
L	160	28	1" NPT	47,0	30,5	48	25,0	36	41	WE-L-28-1"-NPT

RACOR MACHO DE CODO ROSCA NPT ACERO INOXIDABLE



Series	Presión PN	Tubo O.D. D1	Rosca	Dimensiones aproximadas						Código
			G	L1	L2	L3	i	SW2	SW3	
S	630	6	1/4" NPT	31	16,0	26	15,0	12	17	WE-S-06-1/4"-NPT
S	630	8	1/4" NPT	32	17,0	27	15,0	14	19	WE-S-08-1/4"-NPT
S	630	10	3/8" NPT	34	17,5	28	15,3	17	22	WE-S-10-3/8"-NPT
S	630	12	3/8" NPT	38	21,5	28	15,3	17	24	WE-S-12-3/8"-NPT
S	630	12	1/2" NPT	39	21,5	34	20,0	17	24	WE-S-12-1/2"-NPT
S	400	16	1/2" NPT	43	24,5	36	20,0	24	30	WE-S-16-1/2"-NPT
S	400	20	3/4" NPT	48	26,5	42	20,0	27	36	WE-S-20-3/4"-NPT
S	400	25	1" NPT	54	30,0	48	25,0	36	46	WE-S-25-1"-NPT

RACOR MANOMETRO ROSCA HEMBRA GAS ACERO INOXIDABLE

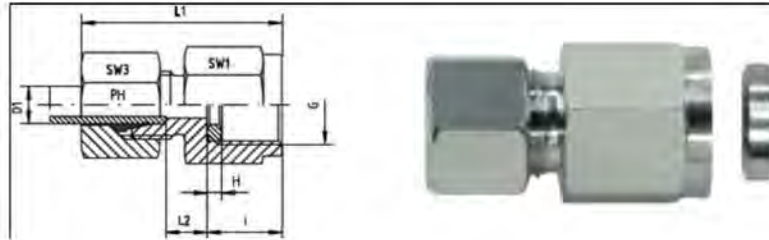

Series	Presión PN	Tubo O.D. D1	Rosca G	Dimensiones aproximadas						Código
				L1	L2	i	H	SW1	SW3	
L	315	12	G 1/4 "	38	8,5	14,5	4,5	19	22	MV-L-12-G 1/4 "

RACOR MANOMETRO ROSCA NPT ACERO INOXIDABLE

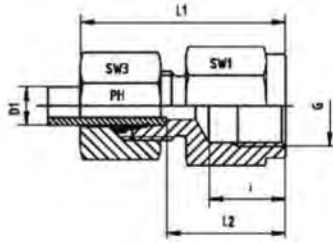

Series	Presión PN	Tubo O.D. D1	Rosca G	Dimensiones aproximadas					Código
				L1	L2	i	SW1	SW3	
L	315	12	1/4" NPT			16,4	19	22	MV-L-12-NPT-1/4 "
S	630	12	1/2" NPT	49	32,5	22,6	27	24	MV-S-12-NPT-1/2 "

**RACOR ORIENTABLE EN CODO EJECUCION ENCHUFABLE ACERO INOXIDABLE
 EVW**

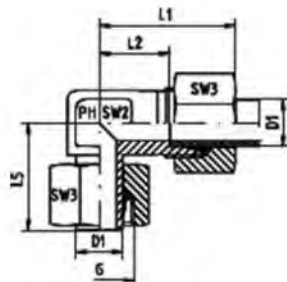

Series	Presión PN	Tubo O.D. D1	Rosca	Dimensiones aproximadas					Código
			G	L1	L2	i	SW1	SW3	
L	315	6	M 12 x 1,5	27	12,0	26,0	12	14	EVW-L-06
L	315	8	M 14 x 1,5	29	14,0	27,5	12	17	EVW-L-08
L	315	10	M 16 x 1,5	30	15,0	29,0	14	19	EVW-L-10
L	315	12	M 18 x 1,5	32	17,0	29,5	17	22	EVW-L-12
L	315	15	M 22 x 1,5	36	21,0	32,5	19	27	EVW-L-15
L	315	18	M 26 x 1,5	40	23,5	35,5	24	32	EVW-L-18
L	160	22	M 30 x 2	44	27,5	38,5	27	36	EVW-L-22
L	160	28	M 36 x 2	47	30,5	43,5	36	41	EVW-L-28
L	160	35	M 45 x 2	56	34,5	54,0	41	50	EVW-L-35
L	160	42	M 52 x 2	63	40,0	56,0	50	60	EVW-L-42
S	630	6	M 14 x 1,5	31	16,0	27,0	12	17	EVW-S-06
S	630	8	M 16 x 1,5	32	17,0	27,5	14	19	EVW-S-08
S	630	10	M 18 x 1,5	34	17,5	30,0	17	22	EVW-S-10
S	630	12	M 20 x 1,5	38	21,5	31,0	17	24	EVW-S-12
S	630	14	M 22 x 1,5	40	22,0	35,0	19	27	EVW-S-14
S	400	16	M 24 x 1,5	43	24,5	36,5	24	30	EVW-S-16
S	400	20	M 30 x 2	48	26,5	44,5	27	36	EVW-S-20
S	400	25	M 36 x 2	54	30,0	50,0	36	46	EVW-S-25
S	400	30	M 42 x 2	62	35,5	55,0	41	50	EVW-S-30
S	250	38	M 52 x 2	72	41,0	63,0	50	60	EVW-S-38

RACOR ORIENTABLE EN T EJECUCION ENCHUFABLE CENTRAL ACERO INOXIDABLE EVT

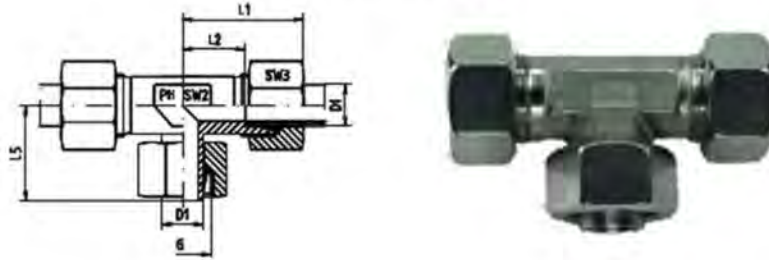

Series	Presión PN	Tubo O.D. D1	Rosca	Dimensiones aproximadas					Código
			G	L1	L2	L5	SW2	SW3	
L	315	6	M 12 x 1,5	27	12,0	26,0	12	14	EVT-L-06
L	315	8	M 14 x 1,5	29	14,0	27,5	12	17	EVT-L-08
L	315	10	M 16 x 1,5	30	15,0	29,0	14	19	EVT-L-10
L	315	12	M 18 x 1,5	32	17,0	29,5	17	22	EVT-L-12
L	315	15	M 22 x 1,5	36	21,0	32,5	19	27	EVT-L-15
L	315	18	M 26 x 1,5	40	23,5	35,5	24	32	EVT-L-18
L	160	22	M 30 x 2	44	27,5	38,5	27	36	EVT-L-22
L	160	28	M 36 x 2	47	30,5	41,5	36	41	EVT-L-28
L	160	35	M 45 x 2	56	34,5	54,0	41	50	EVT-L-35
L	160	42	M 52 x 2	63	40,0	56,0	50	60	EVT-L-42
S	630	6	M 14 x 1,5	31	16,0	27,0	12	17	EVT-S-06
S	630	8	M 16 x 1,5	32	17,0	27,5	14	19	EVT-S-08
S	630	10	M 18 x 1,5	34	17,5	30,0	17	22	EVT-S-10
S	630	12	M 20 x 1,5	38	21,5	31,0	17	24	EVT-S-12
S	630	14	M 22 x 1,5	40	22,0	35,0	19	27	EVT-S-14
S	400	16	M 24 x 1,5	43	24,5	36,5	24	30	EVT-S-16
S	400	20	M 30 x 2	48	26,5	44,5	27	36	EVT-S-20
S	400	25	M 36 x 2	54	30,0	50,0	36	46	EVT-S-25
S	400	30	M 42 x 2	62	35,5	55,0	41	50	EVT-S-30
S	250	38	M 52 x 2	72	41,0	63,0	50	60	EVT-S-38

RACOR ORIENTABLE EN T EJECUCION ENCHUFABLE LATERAL ACERO INOXIDABLE EVL

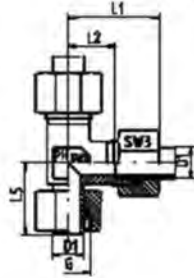

Series	Presión PN	Tubo O.D. D1	Rosca	Dimensiones aproximadas					Código
			G	L1	L2	L5	SW2	SW3	
L	315	12	M 18 x 1,5	32	17,0	29,5	17	22	EVL-L-12

RACOR RECTO PASATABIQUE ACERO INOXIDABLE

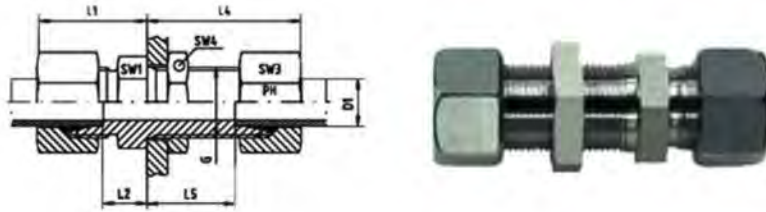

Series	Presión PN	Tubo O.D. D1	Rosca	Dimensiones aproximadas							Código
			G	L1	L2	L4	L5	SW1	SW3	SW4	
L	315	6	M 12 x 1,5	22	7,0	42	27,0	17	14	17	GSV-L-06
L	315	8	M 14 x 1,5	23	8,0	42	27,0	19	17	19	GSV-L-08
L	315	10	M 16 x 1,5	25	10,0	43	28,0	22	19	22	GSV-L-10
L	315	12	M 18 x 1,5	25	10,0	44	29,0	24	22	24	GSV-L-12
L	315	15	M 22 x 1,5	27	12,0	46	31,0	27	27	30	GSV-L-15
L	315	18	M 26 x 1,5	30	13,5	49	32,5	32	32	36	GSV-L-18
L	160	22	M 30 x 2	33	16,5	51	34,5	36	36	41	GSV-L-22
L	160	28	M 36 x 2	35	18,5	52	35,5	41	41	46	GSV-L-28
L	160	35	M 45 x 2	40	18,5	58	36,5	50	50	55	GSV-L-35
L	160	42	M 52 x 2	42	19,0	59	36,0	60	60	65	GSV-L-42
S	630	6	M 14 x 1,5	27	12,0	44	29,0	19	17	19	GSV-S-06
S	630	8	M 16 x 1,5	28	13,0	44	29,0	22	19	22	GSV-S-08
S	630	10	M 18 x 1,5	31	14,5	46	29,5	24	22	24	GSV-S-10
S	630	12	M 20 x 1,5	31	14,5	47	30,5	27	24	27	GSV-S-12
S	630	14	M 22 x 1,5	35	17,0	50	32,0	30	27	30	GSV-S-14
S	400	16	M 24 x 1,5	35	16,5	50	31,5	32	30	32	GSV-S-16
S	400	20	M 30 x 2	39	17,5	55	33,5	41	36	41	GSV-S-20
S	400	25	M 36 x 2	44	20,0	59	35,0	46	46	46	GSV-S-25
S	315	38	M 52 x 2	53	22,0	68	37,0	65	60	65	GSV-S-38

RACOR RECTO ROSCA MACHO FINA METRICA CILINDRICA ACERO INOXIDABLE

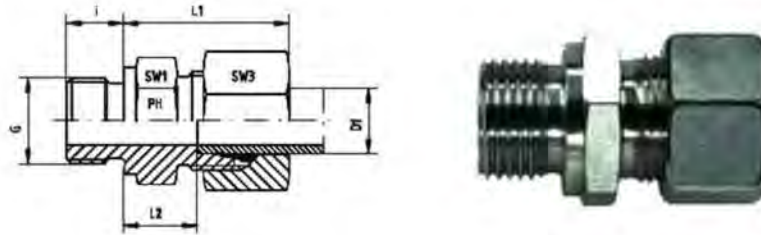

Series	Presión PN	Tubo O.D. D1	Rosca G	Dimensiones aproximadas					Código
				L1	L2	i	SW1	SW3	
S	400	30	M 42 x 2	50,0	23,5	20	50	50	GE-S-30-M 42x2

RACOR RECTO ROSCA MACHO GAS PARA TUBO CILINDRICA ACERO INOXIDABLE

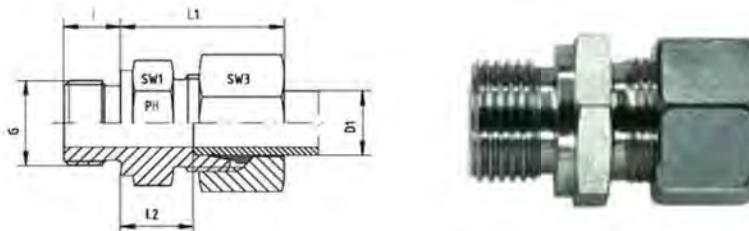

Series	Presión PN	Tubo O.D. D1	Rosca	Dimensiones aproximadas					Código
			G	L1	L2	i	SW1	SW3	
L	315	6	G 1/4 "	27,0	9,0	12	17	14	GE-LR-06-G 1/4 "
L	315	8	G 1/8 "	26,0	9,5	8	14	17	GE-LR-08-G 1/8 "
L	315	8	G 1/4 "	25,0	10,0	12	19	17	GE-LR-08-G 1/4 "
L	315	8	G 3/8 "	28,5	11,5	12	22	17	GE-LR-08-G 3/8 "
L	315	10	G 1/4 "	26,0	11,0	12	19	19	GE-LR-10-G 1/4 "
L	315	10	G 3/8 "	30,5	12,5	12	22	19	GE-LR-10-G 3/8 "
L	315	10	G 1/2 "	32,5	13,0	14	27	19	GE-LR-10-G 1/2 "
L	315	12	G 1/4 "	30,0	12,0	12	19	22	GE-LR-12-G 1/4 "
L	315	12	G 3/8 "	27,0	12,5	12	22	22	GE-LR-12-G 3/8 "
L	315	12	G 1/2 "	31,0	13,0	14	27	22	GE-LR-12-G 1/2 "
L	315	15	G 1/2 "	29,0	14,0	14	27	27	GE-LR-15-G 1/2 "
L	315	18	G 3/8 "	31,0	12,5	12	27	32	GE-LR-18-G 3/8 "
L	315	18	G 1/2 "	31,0	14,5	14	27	32	GE-LR-18-G 1/2 "
L	315	18	G 3/4 "	34,0	14,5	16	32	32	GE-LR-18-G 3/4 "
L	160	22	G 3/4 "	33,0	16,5	16	32	36	GE-LR-22-G 3/4 "
L	160	28	G 1 "	34,0	17,5	18	41	41	GE-LR-28-G 1 "
L	160	35	G 1 "	42,0	17,5	18	46	50	GE-LR-35-G 1 "
L	160	35	G 1 1/4 "	39,0	17,5	20	50	50	GE-LR-35-G 1 1/4 "
L	160	42	G 1 1/2 "	47,0	19,0	22	55	60	GE-LR-42-G 1 1/2 "

RACOR RECTO ROSCA MACHO GAS PARA TUBO CILINDRICA ACERO INOXIDABLE

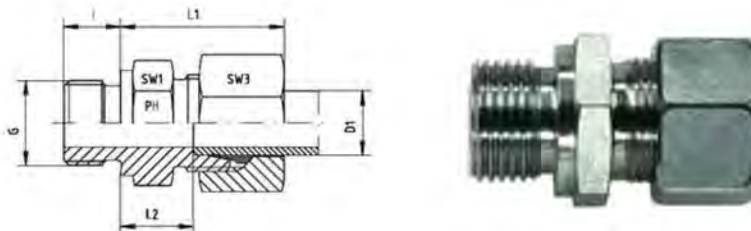

Series	Presión PN	Tubo O.D. D1	Rosca	Dimensiones aproximadas					Código
			G	L1	L2	i	SW1	SW3	
S	630	6	G 1/4 "	28,0	13,0	12	19	17	GE-SR-06-G 1/4 "
S	630	8	G 1/4 "	30,0	15,0	12	19	19	GE-SR-08-G 1/4 "
S	630	8	G 3/8 "		15,5	12	22	19	GE-SR-08-G 3/8 "
S	630	10	G 1/4 "		14,5	12	19	22	GE-SR-10-G 1/4 "
S	630	10	G 3/8 "	31,0	15,0	12	22	22	GE-SR-10-G 3/8 "
S	630	12	G 1/2 "	34,0	17,5	14	27	24	GE-SR-12-G 1/2 "
S	630	14	G 3/8 "		17,0	12	24	27	GE-SR-14-G 3/8 "
S	400	16	G 3/8 "		18,0	12	27	30	GE-SR-16-G 3/8 "
S	400	16	G 1/2 "	37,0	18,5	14	27	30	GE-SR-16-G 1/2 "
S	400	20	G 1/2 "		20,5	14	32	36	GE-SR-20-G 1/2 "
S	400	20	G 3/4 "	42,0	20,5	16	32	36	GE-SR-20-G 3/4 "
S	400	25	G 1 "	47,0	23,0	18	41	46	GE-SR-25-G 1 "
S	400	30	G 3/4 "		25,5	16	46	50	GE-SR-30-G 3/4 "
S	400	30	G 1 1/4 "	50,0	23,5	20	50	50	GE-SR-30-G 1 1/4 "
S	315	38	G 1 1/4 "		23,0	20	55	60	GE-SR-38-G 1 1/4 "
S	315	38	G 1 1/2 "	57,0	26,0	22	55	60	GE-SR-38-G 1 1/2 "

RACOR RECTO ROSCA MACHO NPT ACERO INOXIDABLE

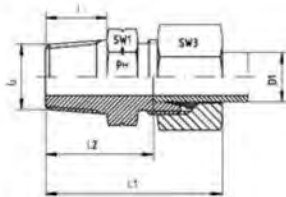

Series	Presión PN	Tubo O.D. D1	Rosca	Dimensiones aproximadas					Código
			G	L1	L2	i	SW1	SW3	
L	315	6	1/8 NPT "	32	17,0	10,0	12	14	GE-L-06-1/8"-NPT
L	315	6	1/4 NPT "	38	23,0	15,0	17	14	GE-L-06-1/4"-NPT
L	315	6	1/2 NPT "	44	29,0	20,0	22	14	GE-L-10-1/2"-NPT
L	315	8	1/8 NPT "	33	18,0	10,0	14	17	GE-L-08-1/8"-NPT
L	315	8	1/4 NPT "	38	23,0	15,0	17	17	GE-L-08-1/4"-NPT
L	315	8	3/8 NPT "	38	23,0	15,3	19	17	GE-L-08-3/8"-NPT
L	315	8	1/2 NPT "	44	29,0	20,0	24	17	GE-L-08-1/2"-NPT
L	315	10	1/8 NPT "	33	18,0	10,0	17	19	GE-L-10-1/8"-NPT
L	315	10	1/4 NPT "	39	24,0	15,0	17	19	GE-L-10-1/4"-NPT
L	315	10	3/8 NPT "	40	25,0	15,3	19	19	GE-L-10-3/8"-NPT
L	315	12	1/4 NPT "	40	25,0	15,0	19	22	GE-L-12-1/4"-NPT
L	315	12	3/8 NPT "	40	25,0	15,3	19	22	GE-L-12-3/8"-NPT
L	315	12	1/2 NPT "	45	30,0	20,0	22	22	GE-L-12-1/2"-NPT
L	315	15	1/2 NPT "	46	31,0	20,0	24	27	GE-L-15-1/2"-NPT
L	315	18	1/2 NPT "	48	31,5	20,0	27	32	GE-L-18-1/2"-NPT
L	160	22	3/4 NPT "	50	33,5	20,0	32	36	GE-L-22-3/4"-NPT
L	160	28	1 NPT "	56	39,5	25,0	41	41	GE-L-28-1"-NPT
L	160	35	1 1/4 NPT "	62	40,5	25,5	46	50	GE-L-35-1 1/4"-NPT
L	160	42	1 1/4 NPT "	65	42,0	25,5	55	60	GE-L-42-1 1/4"-NPT
L	160	42	1 1/2 NPT "	65	42,0	26,0	55	60	GE-L-42-1 1/2"-NPT

RACOR RECTO ROSCA MACHO NPT ACERO INOXIDABLE

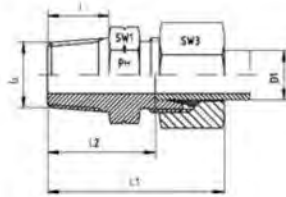

Series	Presión PN	Tubo O.D. D1	Rosca	Dimensiones aproximadas					Código
			G	L1	L2	i	SW1	SW3	
S	630	6	1/4 NPT "	43	28,0	15,0	17	17	GE-S-06-1/4"-NPT
S	630	8	1/4 NPT "	43	28,0	15,0	17	19	GE-S-08-1/4"-NPT
S	630	10	1/4 NPT "	44	27,5	15,0	19	22	GE-S-10-1/4"-NPT
S	630	10	3/8 NPT "	44	27,5	15,3	19	22	GE-S-10-3/8"-NPT
S	630	12	3/8 NPT "	46	29,5	15,3	22	24	GE-S-12-3/8"-NPT
S	630	12	1/2 NPT "	51	34,5	20,0	22	24	GE-S-12-1/2"-NPT
S	400	16	3/8 NPT "	49	30,5	15,3	27	30	GE-S-16-3/8"-NPT
S	400	16	1/2 NPT "	54	35,5	20,0	27	30	GE-S-16-1/2"-NPT
S	400	20	3/4 NPT "	59	37,5	20,0	32	36	GE-S-20-3/4"-NPT
S	400	25	3/4 NPT "	64	40,0	20,0	41	46	GE-S-25-3/4"-NPT
S	400	25	1 NPT "	69	45,0	25,0	41	46	GE-S-25-1"-NPT
S	400	30	1 1/4 NPT "	73	46,5	25,5	46	50	GE-S-30-1 1/4"-NPT
S	315	38	1 1/2 NPT "	80	49,0	26,0	55	60	GE-S-38-1 1/2"-NPT

RACOR RECTO ROSCA MACHO UN/UNF ACERO INOXIDABLE

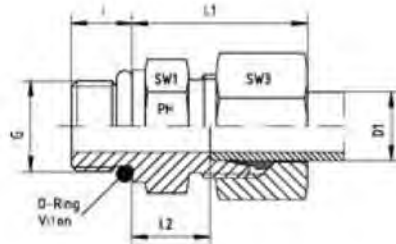

Series	Presión PN	Tubo O.D. D1	Rosca	Dimensiones aproximadas					O-ring	Código
			G	L1	L2	i	SW1	SW3		
S	400	16	3/4-16" UNF	37,0	18,5	11,2	27	30	16,36 x 2,20	GE-S-16-3/4"-UNF
S	400	20	3/4-16" UNF	42,0	20,5	11,2	32	36	16,36 x 2,20	GE-S-20-3/4"-UNF
S	400	20	7/8-14" UNF	42,0	20,5	12,7	32	36	19,18 x 2,46	GE-S-20-7/8"-UNF
S	400	20	1 1/16-12" UN	42,0	20,5	15,0	32	36	23,47 x 2,95	GE-S-20-1 1/16"-UN
S	400	20	1 5/16-12" UN		22,5	15,0	41	36	29,74 x 2,95	GE-S-25-1 5/16"-UN
S	315	38	1 7/8-12" UN	57,0	26,0	15,0	55	60	43,69 x 3,00	GE-S-38-1 7/8"-UN

RACOR RECTO UNION ACERO INOXIDABLE

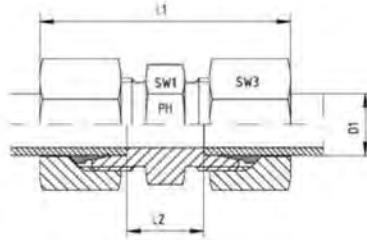

Series	Presión PN	Tubo O.D. D1	Dimensiones aproximadas				Código
			L1	L2	SW1	SW3	
L	315	6	44,0	10	12	14	GV-L-06
L	315	8	45,0	11	14	17	GV-L-08
L	315	10	48,0	13	17	19	GV-L-10
L	315	12	49,0	14	19	22	GV-L-12
L	315	15	54,0	16	24	27	GV-L-15
L	315	18	56,0	16	27	32	GV-L-18
L	160	22	63,0	20	32	36	GV-L-22
L	160	28	65,0	21	41	41	GV-L-28
L	160	35	74,0	20	46	50	GV-L-35
L	160	42	75,0	21	55	60	GV-L-42
S	630	6	50,0	16	14	17	GV-S-06
S	630	8	52,0	18	17	19	GV-S-08
S	630	10	54,0	17	19	22	GV-S-10
S	630	12	57,0	19	22	24	GV-S-12
S	400	16	65,0	21	27	30	GV-S-16
S	400	20	73,0	23	32	36	GV-S-20
S	400	25	84,0	26	41	46	GV-S-25
S	400	30	88,0	27	46	50	GV-S-30
S	315	38	99,0	29	55	60	GV-S-38

RACOR SOLDABLE RECTO ACERO INOXIDABLE

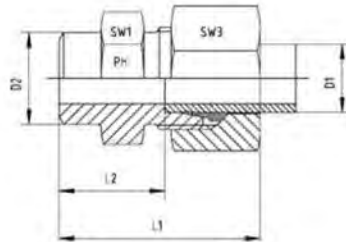

Series	Presión PN	Tube O.D.		Dimensiones aproximadas				Código
		D1	D2	L1	L2	SW1	SW3	
L	315	6	10	29	14,0	12	14	ASV-L-06
L	315	8	12	31	16,0	14	17	ASV-L-08
L	315	10	14	33	18,0	17	19	ASV-L-10
L	315	12	16	33	18,0	19	27	ASV-L-12
L	315	15	19	37	22,0	22	27	ASV-L-15
L	315	18	22	40	23,5	27	32	ASV-L-18
L	160	22	27	45	28,5	32	36	ASV-L-22
L	160	28	32	47	30,5	41	41	ASV-L-28
L	160	35	40	54	32,5	46	50	ASV-L-35
L	160	42	46	58	35,0	55	60	ASV-L-42
S	630	6	11	34	19,0	14	17	ASV-S-06
S	630	8	13	36	21,0	17	19	ASV-S-08
S	630	10	15	39	22,5	19	22	ASV-S-10
S	630	12	17	41	24,5	22	24	ASV-S-12
S	630	14	19	45	27,0	24	27	ASV-S-14
S	400	16	21	45	26,5	27	30	ASV-S-16
S	400	20	26	51	29,5	32	36	ASV-S-20
S	400	25	31	56	32,0	41	46	ASV-S-25
S	400	30	36	62	35,5	46	50	ASV-S-30

REDUCCION DE ROSCA GAS PARA TUBO CILINDRICA ACERO INOXIDABLE

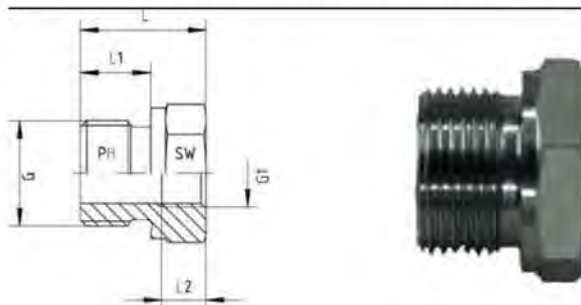

Presión PN	Rosca macho G	Rosca hembra G1	Dimensiones aproximadas				Forma	Código
			L	L1	L2	SW		
630	G 3/8 "	G 1/8 "	22,5	12,0	8,0	22	A	GRI-3/8" X 1/8"
400	G 1/2 "	G 1/4 "	24,0	14,0	12,0	27	A	GRI-1/2" X 1/4"
400	G 3/4 "	G 3/8 "	26,0	16,0	13,0	32	A	GRI-3/4" X 3/8"
400	G 3/4 "	G 1/4 "	26,0	16,0	12,0	32	A	GRI-3/4" X 1/4"
400	G 1 "	G 1/2 "	29,0	18,0	14,0	41	A	GRI-1" X 1/2"
400	G 1 "	G 3/8 "	29,0	18,0	12,0	41	A	GRI-1" X 3/8"

REDUCCION DE ROSCA GAS PARA TUBO CILINDRICA ACERO INOXIDABLE

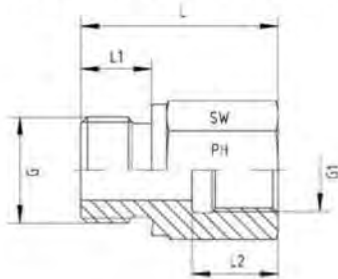

Presión PN	Rosca macho G	Rosca hembra G1	Dimensiones aproximadas				Forma	Código
			L	L1	L2	SW		
630	G 3/8 "	G 1/4 "	36,0	12,0	17,0	22	B	GRI-3/8" X 1/4"
400	G 1/2 "	G 3/8 "	36,0	14,0	17,0	27	B	GRI-1/2" X 3/8"
400	G 3/4 "	G 1/2 "	41,0	16,0	20,0	32	B	GRI-3/4" X 1/2"
400	G 1 "	G 3/4 "	47,0	18,0	22,0	41	B	GRI-1" X 3/4"

TAPON DE CIERRE CON ARISTA DE ESTANQUEIDAD ACERO INOXIDABLE

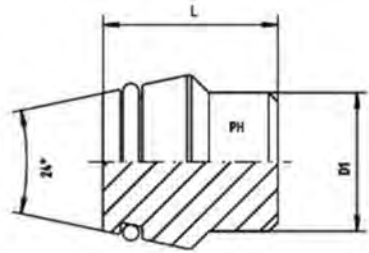

Serie	Presión PN	Tubo O.D. D1	L	Código
S	400	16	20,0	VKA-S-16

TAPON ROSCADO PARA TUBO ACERO INOXIDABLE

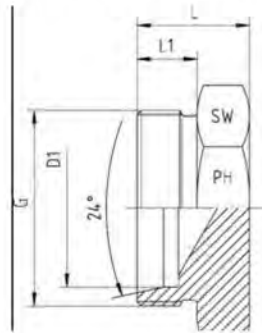

Series	Presión PN	Tubo O.D. D1	Rosca	Dimensiones aproximadas			Código
			G	L	L1	SW	
L	315	6	M 12 x 1,5	14	10	12	XROV-L-06
L	315	8	M 14 x 1,5	15	10	14	XROV-L-08
L	315	10	M 16 x 1,5	16	11	17	XROV-L-10
L	315	12	M 18 x 1,5	17	11	19	XROV-L-12
L	315	15	M 22 x 1,5	18	12	24	XROV-L-15
L	315	18	M 26 x 1,5	19	12	27	XROV-L-18
L	160	22	M 30 x 2	21	14	32	XROV-L-22
L	160	28	M 36 x 2	22	14	41	XROV-L-28
L	160	35	M 45 x 2	25	16	46	XROV-L-35
L	160	42	M 52 x 2	27	16	55	XROV-L-42
S	630	6	M 14 x 1,5	18	12	14	XROV-S-06
S	630	8	M 16 x 1,5	20	12	17	XROV-S-08
S	630	10	M 18 x 1,5	20	12	19	XROV-S-10
S	630	12	M 20 x 1,5	22	12	22	XROV-S-12
S	630	14	M 22 x 1,5	24	14	24	XROV-S-14
S	400	16	M 24 x 1,5	24	14	27	XROV-S-16
S	400	20	M 30 x 2	28	16	32	XROV-S-20
S	400	25	M 36 x 2	32	18	41	XROV-S-25
S	400	30	M 42 x 2	34	20	46	XROV-S-30
S	315	38	M 52 x 2	39	22	55	XROV-S-38

TAPON ROSCADO ROSCA MACHO GAS PARA TUBO CILINDRICA PEFLEX ACERO INOXIDABLE

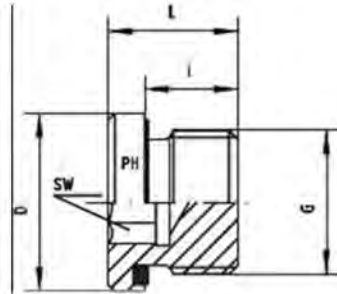

Presión PN	Rosca: Métrica-Paralela G	Dimensiones aproximadas				Código
		D	L	i	SW	
400	1/8 "	14	12,0	8	5	VST-R 1/8 "-wd
400	1/4 "	19	17,0	12	6	VST-R 1/4 "-wd

T-RACOR MACHO ROSCA FINA METRICA CONICA ACERO INOXIDABLE

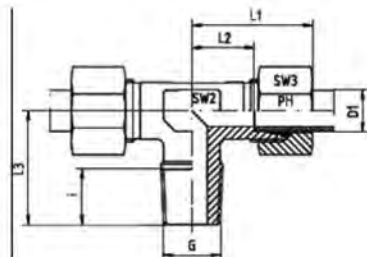

Series	Presión PN	Tubo O.D. D1	Rosca G	Dimensiones aproximadas						Código
				L1	L2	L3	i	SW2	SW3	
L	315	15	M 18 x 1,5 keg	36	21,0	32	12	19	27	TE-L-15-M 18x1,5-k
L	315	18	M 22 x 1,5 keg	40	23,5	36	14	24	32	TE-L-18-M 22x1,5-k

TUERCA PARA RACOR ACERO INOXIDABLE

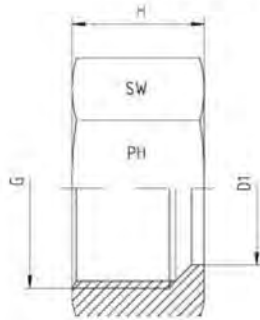

Tubo O.D D1	Rosca G	Dimensiones aproximadas		DN 3861	ISO 8434-1	Código
		SW	H			
6	M 12 x 1,5	14	14,5		N-L 6	ÜWM-L-06
8	M 14 x 1,5	17	14,5		N-L 8	ÜWM-L-08
10	M 16 x 1,5	19	15,5		N-L 10	ÜWM-L-10
12	M 18 x 1,5	22	15,5		N-L 12	ÜWM-L-12
15	M 22 x 1,5	27	17,0		N-L 15	ÜWM-L-15
18	M 26 x 1,5	32	18,0		N-L 18	ÜWM-L-18
22	M 30 x 2	36	20,0		N-L 22	ÜWM-L-22
28	M 36 x 2	41	21,0		N-L 28	ÜWM-L-28
35	M 45 x 2	50	24,0		N-L 35	ÜWM-L-35
42	M 52 x 2	60	24,0		N-L 42	ÜWM-L-42
6	M 14 x 1,5	17	16,5		N-S 6	ÜWM-S-06
8	M 16 x 1,5	19	16,5		N-S 8	ÜWM-S-08
10	M 18 x 1,5	22	17,5		N-S 10	ÜWM-S-10
12	M 20 x 1,5	24	17,5		N-S 12	ÜWM-S-12
16	M 24 x 1,5	30	20,5		N-S 16	ÜWM-S-16
20	M 30 x 2	36	24,0		N-S 20	ÜWM-S-20
25	M 36 x 2	46	27,0		N-S 25	ÜWM-S-25
30	M 42 x 2	50	29,0		N-S 30	ÜWM-S-30
38	M 52 x 2	60	32,5		N-S 38	ÜWM-S-38

UNION DE REDUCCION CON HEXAGONO PARA CONTRATUERCA ACERO INOXIDABLE

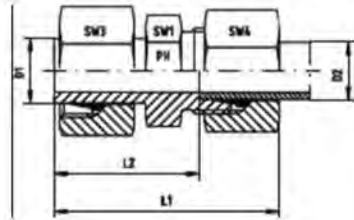

Series	Presión PN	Tubo O.D. D1	Tubo O.D. D2	Dimensiones aproximadas					Código
				L1	L2	SW1	SW3	SW4	
L	160	28	12	51,0	36,0	30	41	22	KOR-L-28/12
S	400	16	12	55,0	38,5	22	30	24	KOR-S-16/12